

ENCLOSED GAS PRODUCTION UNIT

Sizing and Options Form

Contact an Exterran sales representative or email PEQ.Proposals@exterran.com to submit sizing information and obtain a quote.

Well 1 Sizing

Gas Flow Rate, MMscfd: _____ @ _____ psig
 Oil Flow Rate, bpd: _____ @ _____ sp. gr.
 Water Flow Rate, bpd: _____ @ _____ sp. gr.
 Shut-in Tubing Pressure: _____ psig
 Inlet Flow Pressure: _____ psig
 Inlet Flow Temperature: _____ °F
 Outlet Pressure: _____ psig
 Outlet Temperature: _____ °F
 Sour Service: Yes _____ No _____
 CO₂: _____ mol%
 H₂S: _____ ppm

Well 2 Sizing

Gas Flow Rate, MMscfd: _____ @ _____ psig
 Oil Flow Rate, bpd: _____ @ _____ sp. gr.
 Water Flow Rate, bpd: _____ @ _____ sp. gr.
 Shut-in Tubing Pressure: _____ psig
 Inlet Flow Pressure: _____ psig
 Inlet Flow Temperature: _____ °F
 Outlet Pressure: _____ psig
 Outlet Temperature: _____ °F
 Sour Service: Yes _____ No _____
 CO₂: _____ mol%
 H₂S: _____ ppm

Well 3 Sizing

Gas Flow Rate, MMscfd: _____ @ _____ psig
 Oil Flow Rate, bpd: _____ @ _____ sp. gr.
 Water Flow Rate, bpd: _____ @ _____ sp. gr.
 Shut-in Tubing Pressure: _____ psig
 Inlet Flow Pressure: _____ psig
 Inlet Flow Temperature: _____ °F
 Outlet Pressure: _____ psig
 Outlet Temperature: _____ °F
 Sour Service: Yes _____ No _____
 CO₂: _____ mol%
 H₂S: _____ ppm

Well 4 Sizing

Gas Flow Rate, MMscfd: _____ @ _____ psig
 Oil Flow Rate, bpd: _____ @ _____ sp. gr.
 Water Flow Rate, bpd: _____ @ _____ sp. gr.
 Shut-in Tubing Pressure: _____ psig
 Inlet Flow Pressure: _____ psig
 Inlet Flow Temperature: _____ °F
 Outlet Pressure: _____ psig
 Outlet Temperature: _____ °F
 Sour Service: Yes _____ No _____
 CO₂: _____ mol%
 H₂S: _____ ppm

Options Checklist

- Interchangeable Gas Metering
- Interchangeable Liquid Meter
- Two-Phase Separator
- High/Low Pressure Shutdown
- High/Low Liquid Level Shutdown
- BSL or Burner Management System
- Solar option for BSL
- Stack Arrestor
- Alternative Coil Configurations
- 10,000 or 15,000 MAWP Coil Design
- Gas Leak Detection
- Sour Service
- Remote Monitoring

Notes



ENCLOSED GAS PRODUCTION UNIT

Single, Dual, or Quad Configuration Options

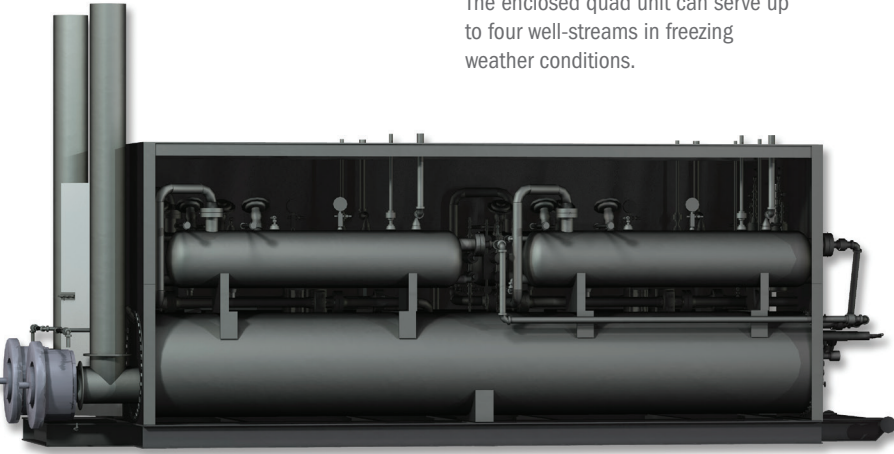

The enclosed quad unit can serve up to four well-streams in freezing weather conditions.

Key Benefits

- **Customizable configurations** allow for easy installation of a different separator, coil, fire tube and meters - have it made your way.
- **Flexible package options** for your specific well-head needs, from SINGLE for one well-stream, to DUAL for two well-streams to QUAD for four well-streams.
- **High performance and dependability** with Exterran's pre-designed construction and rigorous quality control and testing procedures.
- **Easy-to-service, interchangeable components** make field service simple.
- **Durable heater shell** with Exterran's 1/4 inch heavy-duty steel construction.
- **Faster delivery and startup** with Exterran's always in-stock inventory.
- **Save installation and service time** with Exterran pre-engineered design and isometric piping connections.
- **Improved unit efficiency** with Exterran's unique round heater design.
- **Reliable support and service** with technicians and locally stocked spare parts in every major oil & gas producing area.
- **Get your equipment immediately** – it's in stock!

OVERVIEW

The Exterran enclosed gas production unit (EGPU) is an in-stock, pre-engineered, preassembled and integrated package. It is designed to regulate well-stream flow, pressure and temperature, and to separate gas and liquids in cold weather environments.

The EGPU includes a gas-fired heater and a horizontal three-phase separator mounted on an enclosed oilfield skid.

Instrumentation and interconnect piping are operation-ready allowing for quick connection to a natural gas well. The enclosure protects instrumentation and piping even in frigid climates.

Exterran EGPUs are available in single unit, dual unit and quad unit for cost-saving, multi-well service in gas production.

HOW IT WORKS

Gas production units are used on natural gas wells to remove liquids from gas prior to further processing or delivery to a pipeline.

Upon entering the unit the well-stream is heated both before and after flowing through a pressure-reducing choke to prevent freezing of water and condensates.

The well-stream then enters the separator where liquids are diverted against the separator shell and down into the accumulation section. Gas flows upward and exits the separator through a wire mesh mist extractor.

Temperature controllers in the unit maintain the temperature to prevent freezing, overheating, and the formation of hydrates.



ENCLOSED GAS PRODUCTION UNIT

Single, Dual, or Quad Configuration Options

Standard Product Features

- Heavy duty ¼ inch steel line heater enclosure
- Heavy duty oilfield skid with tailboard bar
- Interchangeable three-phase separator
- Interchangeable and removable fire tube
- Interchangeable and removable split coil per API 12K
- Fuel gas scrubber with internal high-level shutdown
- Fuel gas manifold with high & low pressure regulators
- Fuel gas preheat coil
- Long-nose adjustable choke
- Removable stack
- Flame arrestor
- Relief valves
- Temperature controller
- Temperature safety high
- Liquid level controllers
- Non-freeze level control valves
- Pressure gauges



The enclosed single unit package is designed to serve one well-head in cold weather.

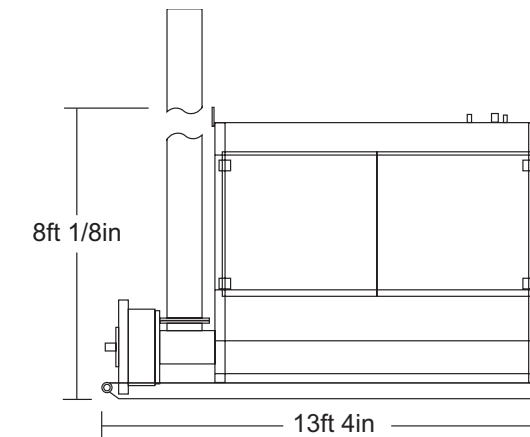

SINGLE UNIT SHIPPING DIMENSIONS

Side View

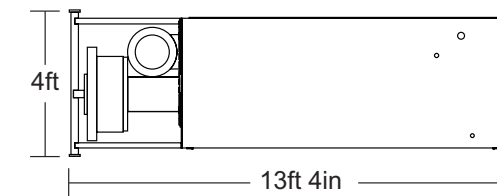

Top View

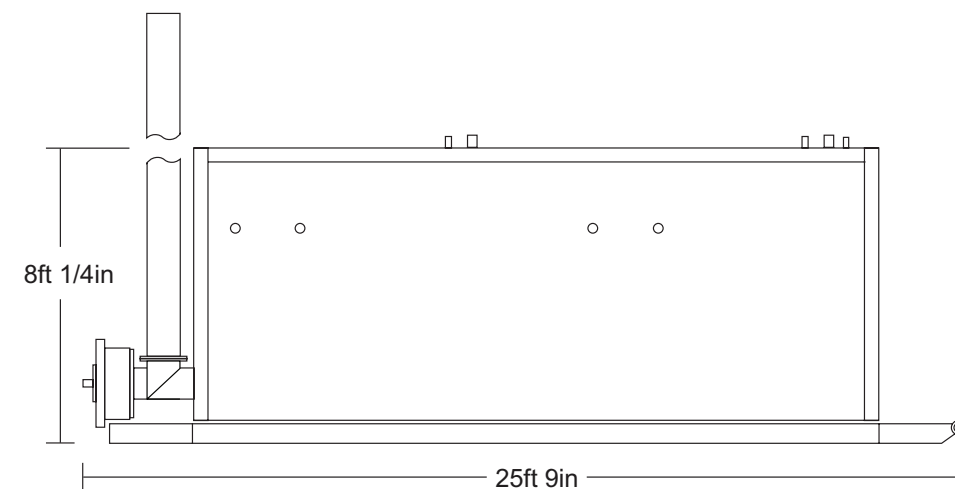

QUAD UNIT SHIPPING DIMENSIONS

Side View

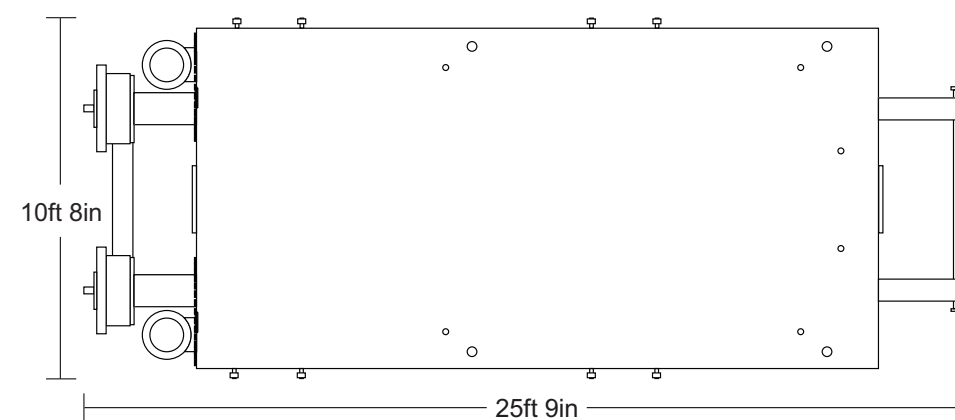

Top View

Shipping dimensions shown here are approximate and may vary. Precise measurements for freight permits should be confirmed prior to shipping.

Specifications for Standard SINGLE Unit Package

Heater			Separator			Coil Size		Coil MAWP psig @ 120°F	Nominal Gas Capacity MMscfd at 1000 psig
Duty MBtu/Hr	OD in	Length ft S/S	MAWP psig @ 120°F	OD in	Length ft S/S	Preheat XXH in	Postheat XH in		
500	36	10	1440	16	7.5	2	2	7800	5.5
750	36	10	1440	20	7.5	2	3	7800	8.0
1000	42	10	1440	24	7.5	3	3	7800	12.0

Specifications for Standard QUAD Unit Package

Heater			Separator			Coil Size		Coil MAWP psig @ 120°F	Nominal Gas Capacity MMscfd at 1000 psig (per well)
Duty MBtu/Hr	OD in	Length ft S/S	MAWP psig @ 120°F	OD in	Length ft S/S	Preheat XXH in	Postheat XH in		
1500	36	20	1440	20	7.5	2	3	7800	8.0
2000	42	20	1440	24	7.5	3	3	7800	12.0